

vtech[®]
Baby

Parent's Guide

Twist 'n' Play Koala



91-003603-001 

VTech understands that a child's needs and abilities change as they grow and with that in mind we develop our toys to teach and entertain at just the right level...

vtech *Baby*

Toys that will stimulate their interest in different textures, sounds and colours

I am...

...responding to colours, sounds and textures

...understanding cause and effect

...learning to touch, reach, grasp, sit-up, crawl and toddle

Birth-36 months



Pre-School

Interactive toys to develop their imagination and encourage language development

I want...

...to get ready for school by starting to learn the alphabet and counting

...my learning to be as fun, easy and exciting as can be

...to show my creativity with drawing and music so my whole brain develops

3-6 years



Electronic Learning Computers

Cool, aspirational and inspiring computers for curriculum related learning

I need...

...challenging activities that can keep pace with my growing mind

...intelligent technology that adapts to my level of learning

...National Curriculum based content to support what I'm learning at school

4-10 years



To learn more about this and other VTech® products, visit www.vtech.co.uk

INTRODUCTION

Thank you for purchasing the **VTech Twist 'n' Play Koala**. Koala has a easy to grip black and white handle for on-the-go fun and visual recognition. Fun sound effects and voices will play when the motion sensor is activated or the heart button is pressed. Twist the ears and spin the beads for even more fun!

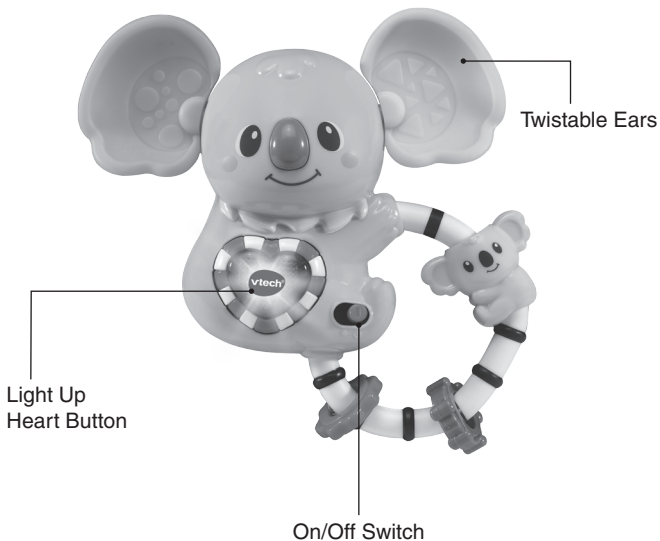

INCLUDED IN THIS PACKAGE

- One **Twist 'n' Play Koala**.
- One Parent's Guide.

WARNING:

All packing materials such as tape, plastic sheets, packaging locks, removable tags, cable ties and packaging screws are not part of this toy and should be discarded for your child's safety.

NOTE: Please keep this Parent's Guide as it contains important information.

Unlock the packaging locks:

- ① Turn the packaging locks anticlockwise several times.
- ② Pull out and discard the packaging locks.

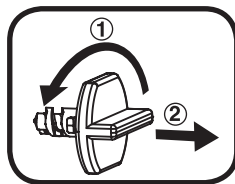

GETTING STARTED

BATTERY INSTALLATION

1. Make sure the unit is turned **OFF**.
2. Locate the battery cover on the back of the unit. Use a screwdriver to loosen the screw.
3. Install 1 new AAA (AM-4/LR03) battery following the diagram inside the battery box. (The use of new alkaline batteries is recommended for maximum performance.)
4. Replace the battery cover and tighten the screw to secure.

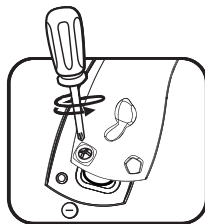

BATTERY NOTICE:

- Use new alkaline batteries or fully charged NI-MH (Nickel Metal-hydride) rechargeable batteries for best performance.
- Use only batteries of the same or equivalent type as recommended.
- Do not mix different types of batteries: alkaline, standard (carbon-zinc) or rechargeable, or new and used batteries.
- Do not use damaged batteries.
- Insert batteries with the correct polarity.
- Do not short-circuit the battery terminals.
- Remove exhausted batteries from the toy.
- Remove batteries during long periods of non-use.
- Do not dispose of batteries in fire.
- Do not charge non-rechargeable batteries.
- Remove rechargeable batteries from the toy before charging (if removable).
- Rechargeable batteries are only to be charged under adult supervision.

Disposal of batteries and product



The crossed-out wheellie bin symbols on products and batteries, or on their respective packaging, indicates they must not be disposed of in domestic waste as they contain substances that can be damaging to the environment and human health.



The chemical symbols Hg, Cd or Pb, where marked, indicate that the battery contains more than the specified value of mercury (Hg), cadmium (Cd) or lead (Pb) set out in Battery Directive (2006/66/EC).



The solid bar indicates that the product was placed on the market after 13th August, 2005.

Help protect the environment by disposing of your product or batteries responsibly.

For more information, please visit:

www.recycle-more.co.uk

www.recyclenow.com

PRODUCT FEATURES

1. On/Off Switch

To turn the unit **ON**, slide the **On/Off Switch** to the **ON** (☺) position. To turn the unit **OFF**, slide the **On/Off Switch** to the **OFF** (●) position.

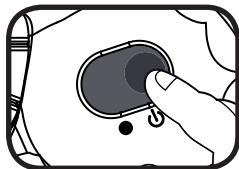

2. Automatic Shut Off

To preserve battery life, the **Twist 'n' Play Koala** will automatically power down after approximately 45 seconds without input. The unit can be turned on again by pressing the light up button.

NOTE: If the unit repeatedly powers down when playing, we recommend changing the batteries.

ACTIVITIES

1. Light Up Heart Button

Press the **Light Up Heart Button** to hear playful songs, phrases and melodies. When a melody is playing, shake the koala to hear fun sounds play over the melody.



2. Motion Sensor

Shake the koala to activate the **Motion Sensor**. You will hear a variety of playful sounds.

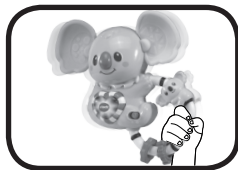

SONG LYRICS

Song 1

Koala kisses for me.
Koala kisses for you.
Koala kisses for everyone.
I am full of love!

Song 2

La-la-la-la, I'm a koala.
I'm silly and smart.
And I love to sing, la-la-la-la!

Song 3

Look at me, I have two big ears.
I'm cute and sweet and friendly.

MELODY LIST

1. A-Tisket, A-Tasket
2. Baa, Baa Black Sheep
3. Diddle, Diddle Dumpling
4. Farmer in the Dell
5. Georgie Porgie
6. Goosey, Goosey Gander
7. Hickory, Dickory Dock
8. Humpty Dumpty
9. Jack Be Nimble
10. Little Miss Muffet
11. London Bridge
12. Pat-a-Cake
13. Ring Around the Rosy
14. Sing a Song of Sixpence
15. This Old Man





CARE & MAINTENANCE

1. Keep the unit clean by wiping it with a slightly damp cloth.
2. Keep the unit out of direct sunlight and away from any direct heat sources.
3. Remove the batteries when the unit is not in use for an extended period of time.
4. Do not drop the unit on a hard surface and do not expose the unit to excess moisture.

TROUBLESHOOTING

If for some reason the unit stops working or malfunctions, please follow these steps:

- 
1. Please turn the unit **OFF**.
 2. Interrupt the power supply by removing the batteries.
 3. Let the unit stand for a few minutes, then replace the batteries.
 4. Turn the unit **ON**. The unit should now be ready to play again.
 5. If the product still does not work, replace with a new set of batteries.
- 

If the problem persists, please call our Consumer Services Department and a service representative will be happy to help you.

CONSUMER SERVICES

Creating and developing VTech products is accompanied by a responsibility that we at VTech® take very seriously. We make every effort to ensure the accuracy of the information, which forms the value of our products. However, errors sometimes can occur. It is important for you to know that we stand behind our products and encourage you to call our Consumer Services Department with

any problems and/or suggestions that you might have. A service representative will be happy to help you.

UK Customers:

Phone: 0330 678 0149 (from UK) or +44 330 678 0149 (outside UK)

Website: www.vtech.co.uk/support

Australian Customers:

Phone: 1800 862 155

Website: support.vtech.com.au

NZ Customers:

Phone: 0800 400 785

Website: support.vtech.com.au

Product Warranty / Consumer Guarantees

UK Customers:

Read our complete warranty policy online at vtech.co.uk/warranty.

Australian Customers:

**VTECH ELECTRONICS (AUSTRALIA) PTY LIMITED –
CONSUMER GUARANTEES**

Under the Australian Consumer Law, a number of consumer guarantees apply to goods and services supplied by VTech Electronics (Australia) Pty Limited. Please refer to vtech.com.au/consumerguarantees for further information.



CLASS 1
LED PRODUCT



**Visit our website for more
information about our products,
downloads, resources and more.**

www.vtech.co.uk
www.vtech.com.au



TM & © 2018 VTech Holdings Limited.
All rights reserved.
Printed in China.
91-003603-001 